

SMART BOOST Methanol/Water Injection Kit Installation

MWI Electrical Sub-system Installation Guide

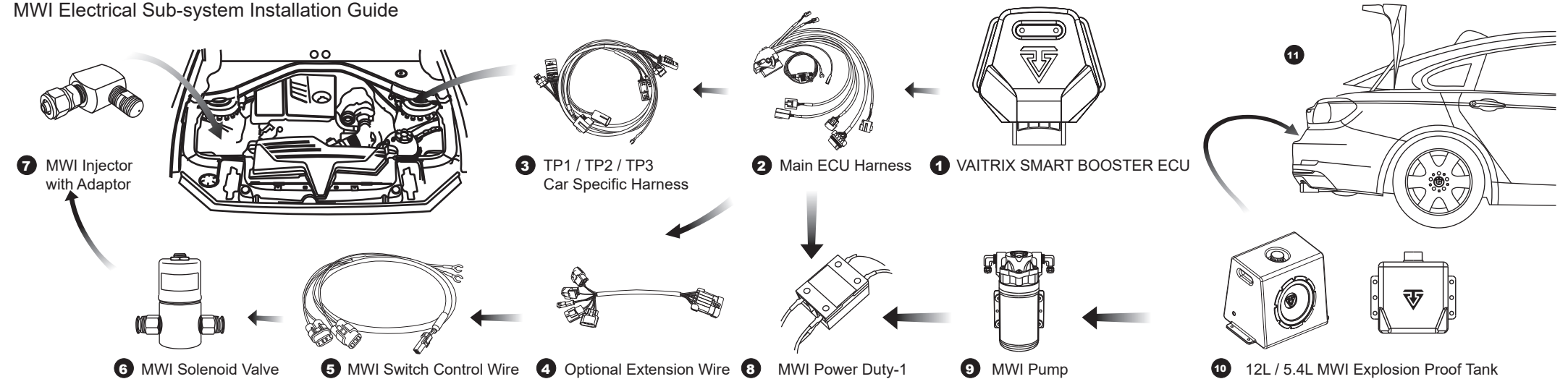

MWI Fluid Sub-system Installation Guide

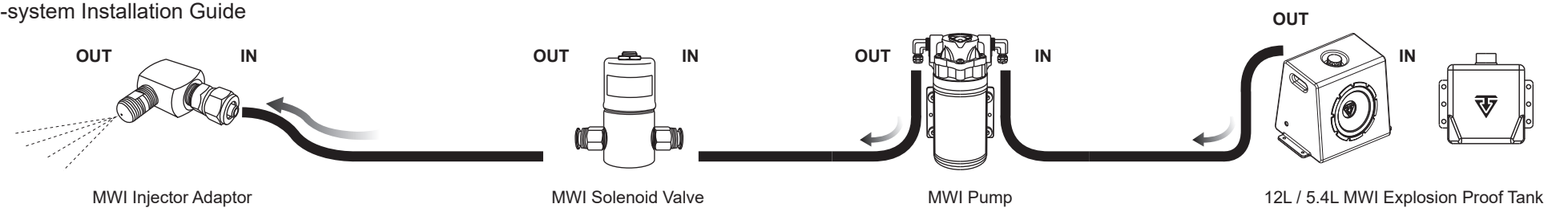

- 1 Four models of VAITRIX SMART BOOSTER are recommended to co-work with the VAITRIX MWI Kit :

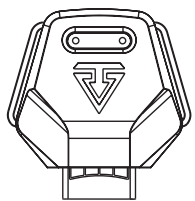

- VAITRIX SMART BOOSTER PRO (Turbo Pressure and MWI)
- VAITRIX SMART BOOSTER PLUS (Turbo Pressure and MWI)
- VAITRIX SMART BOOSTER BASIC (Turbo Pressure only)
- VAITRIX SMART BOOSTER MI (MWI only)

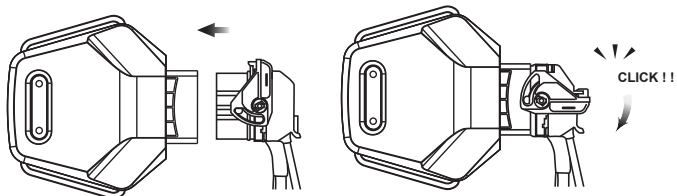

- Connect the VAITRIX SMART BOOSTER ECU with the Main ECU Harness and make sure they're tightly fitted with each other.

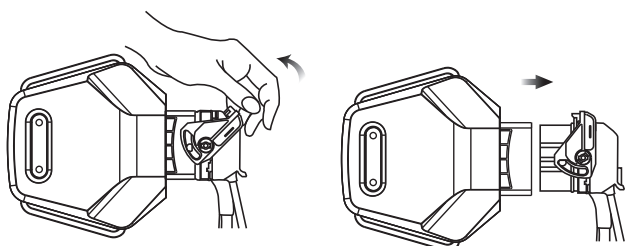

- Connect the VAITRIX BOOSTER ECU with the Main ECU Harness and make sure they're tightly fitted with each other.

2 【The Main ECU Harness】

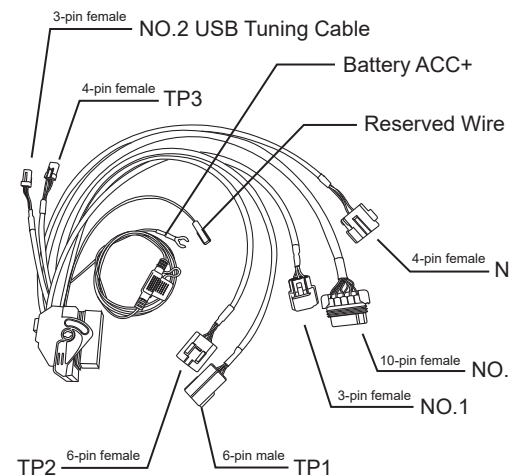

- TP1 (6-pin female) & TP2 (6-pin male) - connect to Car-Model Specific Harness
- NO.1-MWI Power Duty-1
- NO.2-USB Tuning Cable
- NO.3-Optional Extension Wire
- NO.4-Bluetooth Module
- Red Battery ACC+ Wire (Anode 12V)
- 1-pin Reserved Wire
- TP3-Car Specific Harness

★The main ECU harness are packaged separately and are not included in the box.

3 【The Main ECU Harness connect with Optional Extension Wire】

- Connect each wire of the Main Harness with the wire of the Car-Model Specific Harness with the same number label one by one.
- Connect the connectors in other end of the Car-Model Specific Harness to various devices in the engine bay. For the exact location of each device, please refer to the Tuning Installation Manual available in VAITRIX website, we will put a paper of installation guide inside the kit.

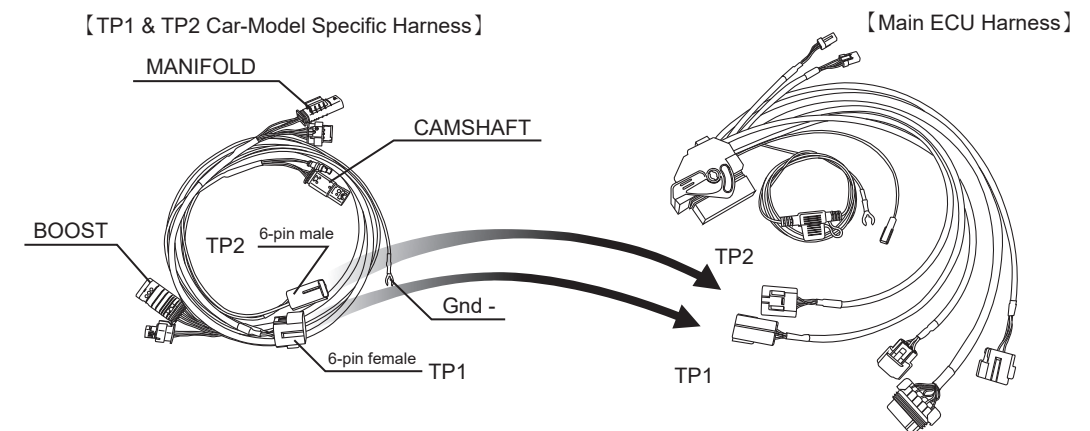

⚠ For the position of MANIFOLD · CAMSHAFT and BOOST connector, please see the diagram attached in wire set. If you have any problem, please reconnect these three connectors to their original factory connectors.

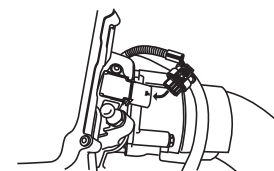

- Please refer to the Installation Manual to find the MANIFOLD sensor connector (located downstream the throttle valve) .

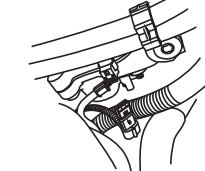

- Please refer to the Installation Manual to find the correct location of the CAMSHAFT sensor connector.

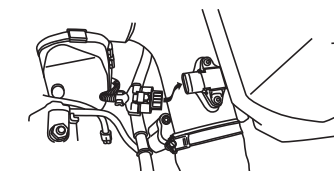

- Please refer to the Installation Manual to find the BOOST sensor connector (located upstream the throttle valve) .

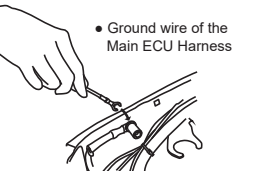

- Make sure the ground wire is connected to an unpainted metal point.

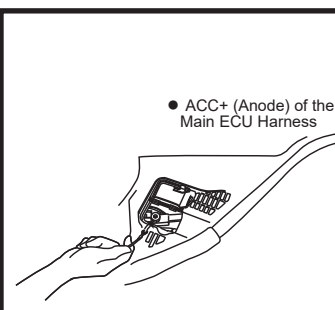

- Make sure the positive terminal should be connected to the positive terminal of the battery.

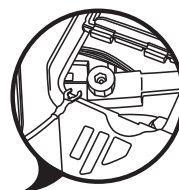

- If you encounter any problem during installation or operation :
 - Remove ACC+ from the car battery to restore factory default.
 - Remove 20A fuse to restore factory default.



Please note that during installation, if the positive and negative wires contact each other or are installed in the wrong position, the internal PCB will be short-circuited and burned.

4 【Optional Extension Wire Explanation】

- Extension Wire No.3 connect with Main ECU Harness No.3

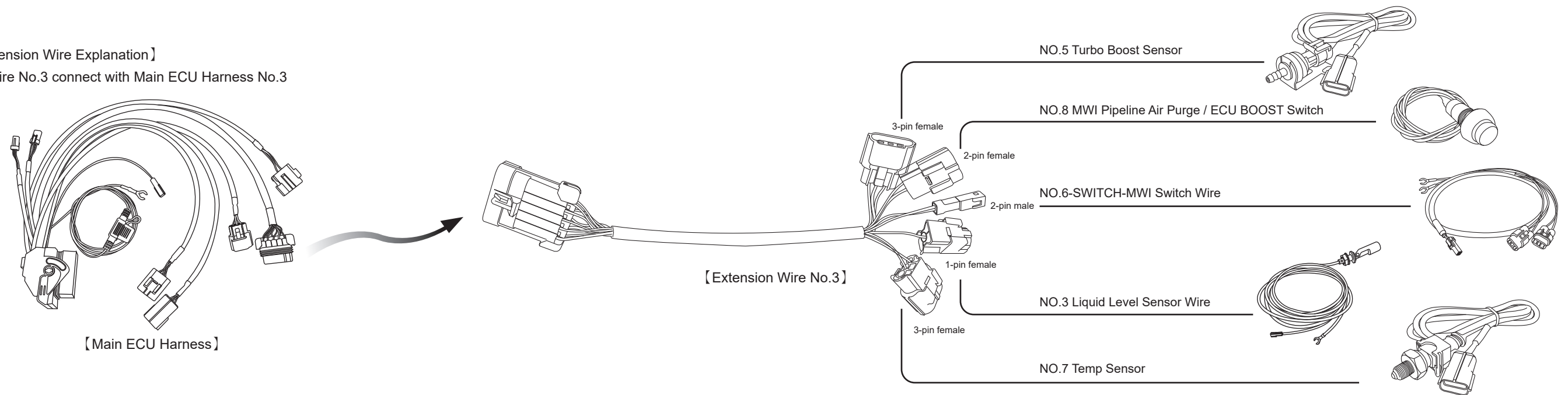

5 【MWI Switch Control Wire】

- NO.6-Extension No.6 Connect to MWI Switch Wire No.6 Connector
- SW1-MWI Solenoid Valve
- SW2-MWI Solenoid Valve(Available for Optional 2nd Valve)
- Gnd-Negative Connect to Unpaint Metal Surface

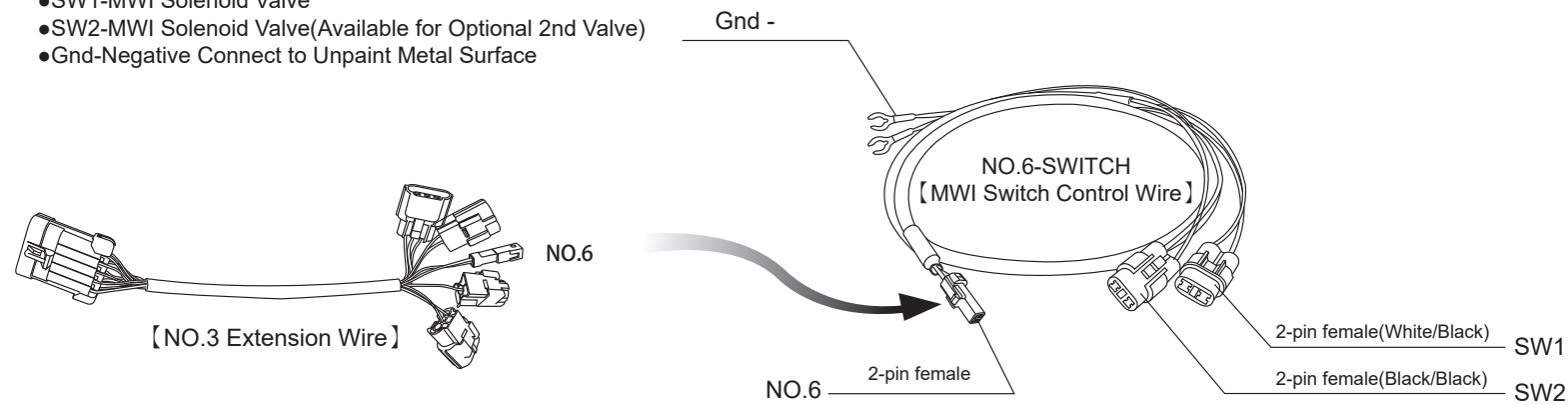

6 【MWI Solenoid Valve】

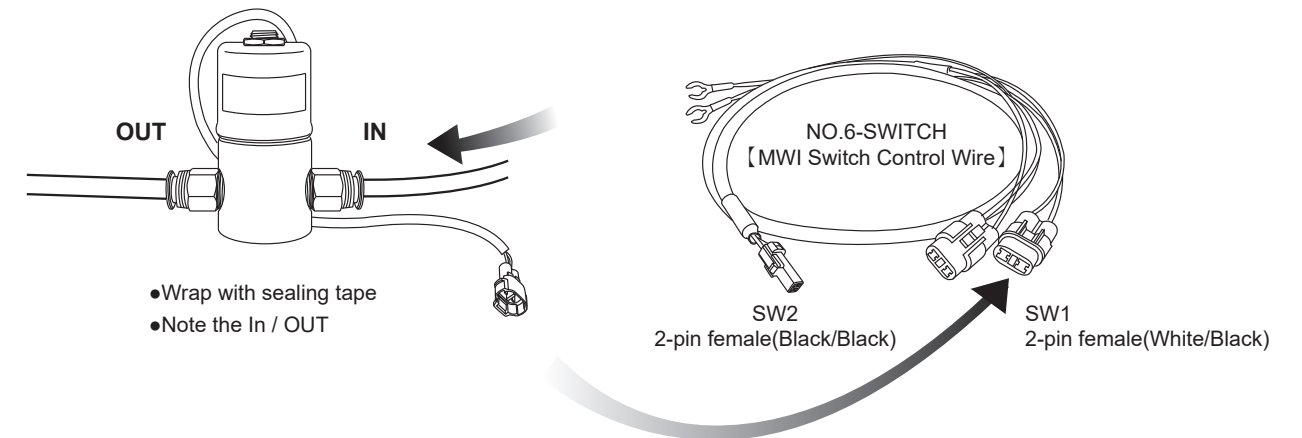

7 【MWI Injector with adaptor】

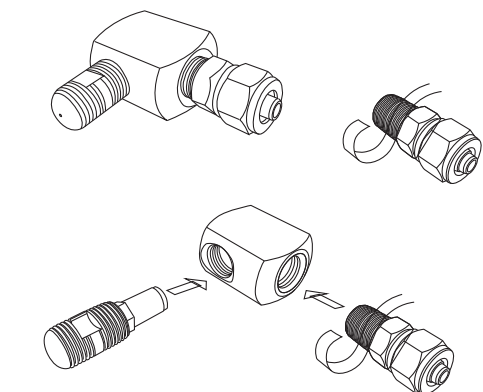

- Caution: Wrap the sealing tape in the opposite direction to the thread

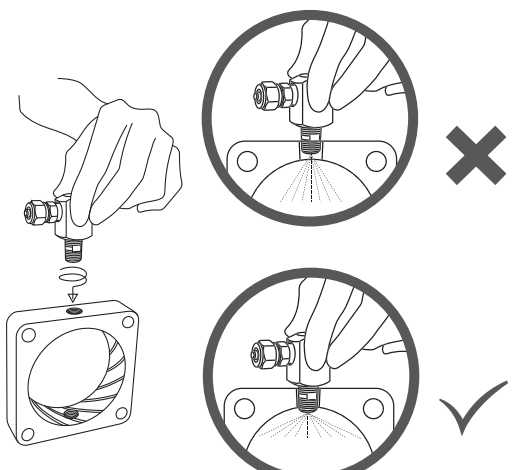

- Mounting Spacer is car-model specific. Choose correct model for your car.

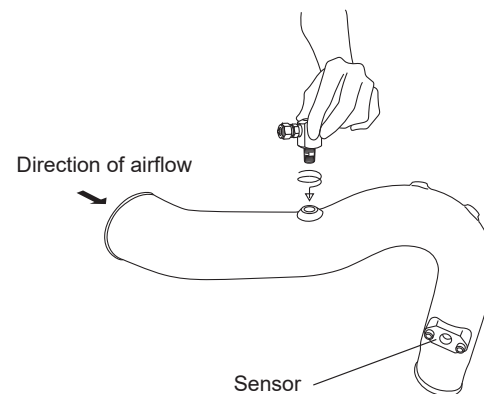

- Intercooler Charge Pipe with injector mounting point is car-model specific. Choose correct model for your car. Note: Before drilling for the injector, make sure the mounting point is upstream the sensor.

8 【MWI Power Wire Duty-1】

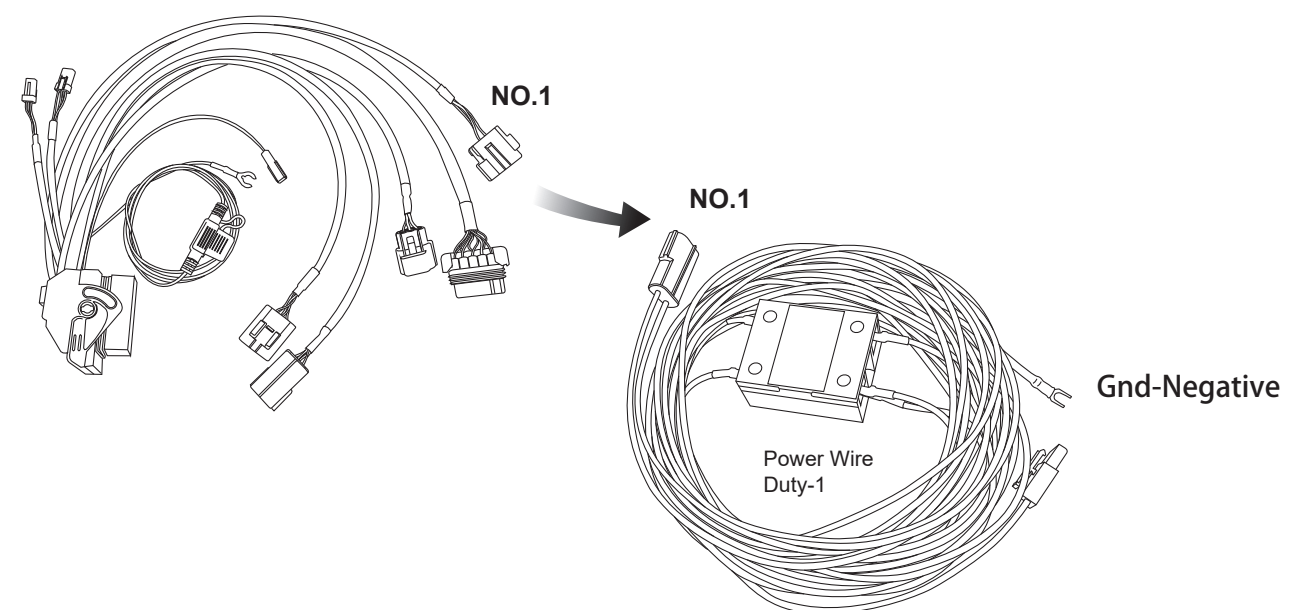

9 【MWI Power Wire Duty-1 & MWI Pump Install】

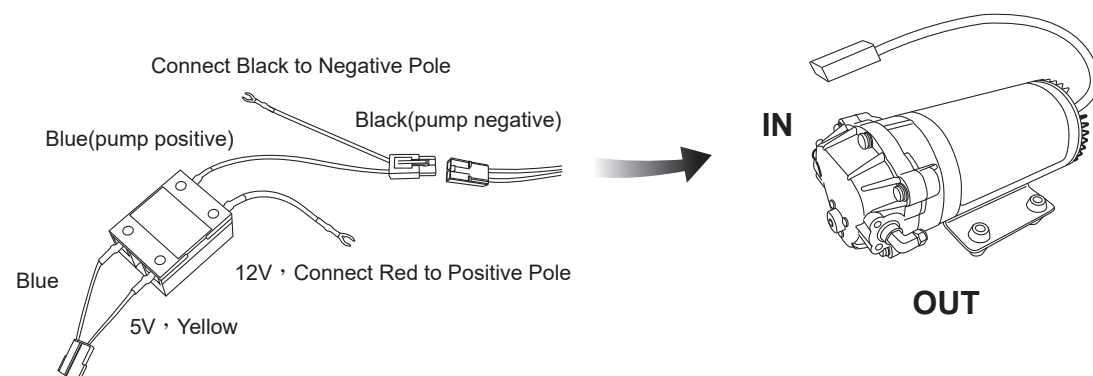

- Connected to the water spray gauge adapter cable assembly (3-pin male connector) (No.1Wire Harness)

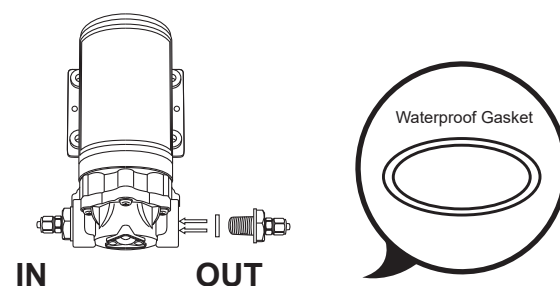

- Please pay attention to IN / OUT
- Waterproof gaskets need to be placed in the inlet/outlet holes of pump.

10 【Methanol Injection Explosion Proof Tank】

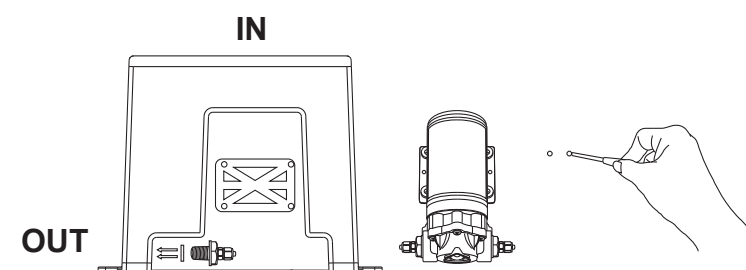

- Please pay attention to OUT.
- Waterproof gasket need to be placed in the outlet hole of methanol / water tank.
- Use screws to secure the pump onto the methanol/water tank.

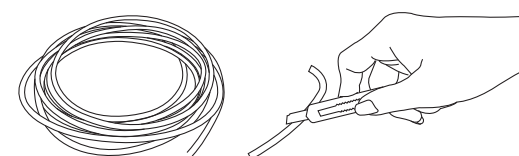

- Please pay attention:
- Do not fold or press the pipe when installing, otherwise it will damage the pipe structure.
 - Cut the pipe with a knife, scissors will deform the pipe.

11 【Install the tank in the trunk area】

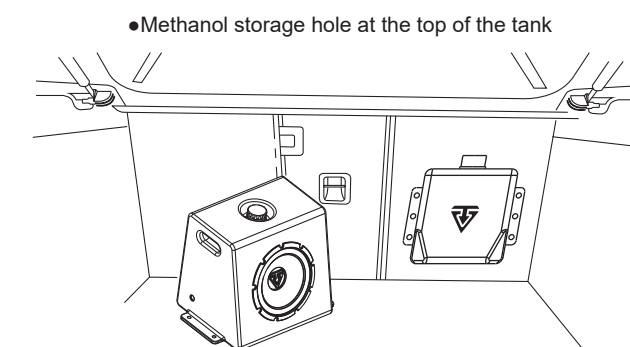

Pump towards the front of the car / logo towards the rear of the car

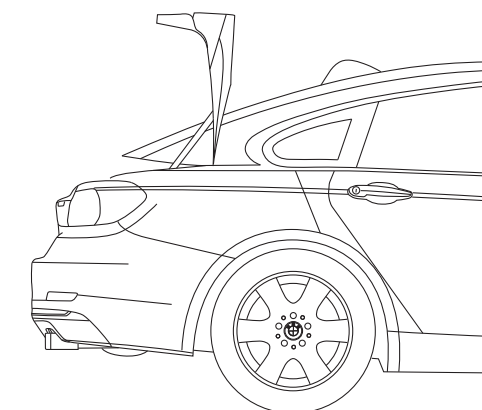

【Key Point of Install Liquid level sensor (optional)】

【External Diagram】

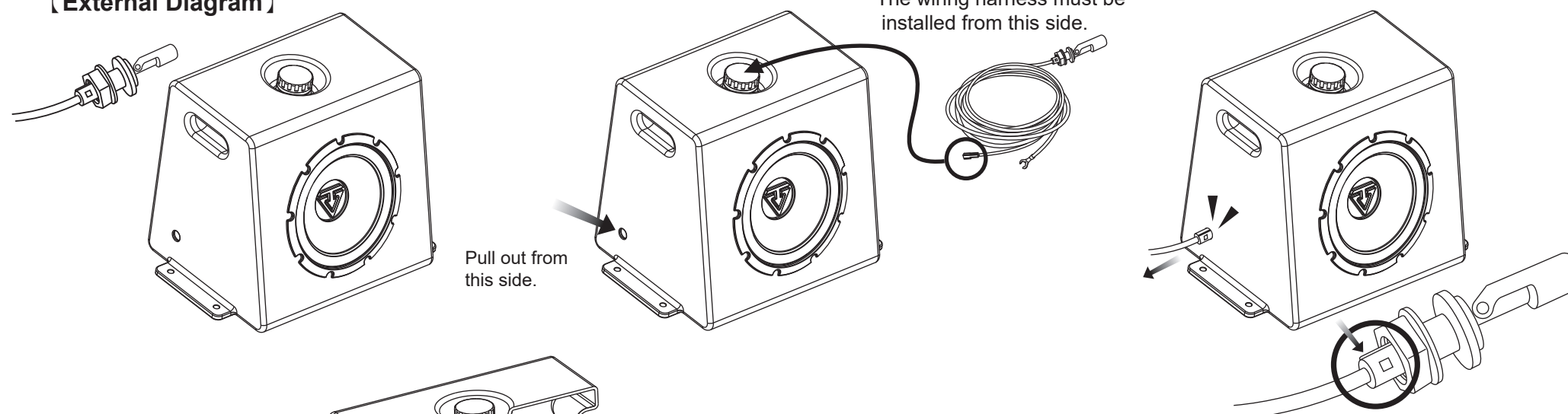

【Internal Diagram】

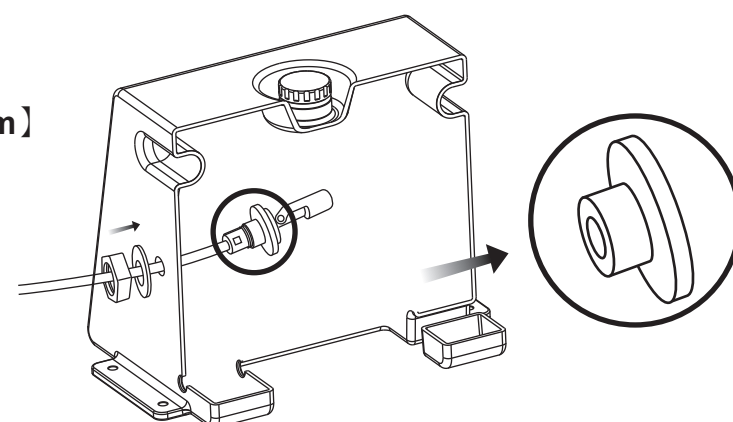

Caution:
White sealing gasket is directional.

Attention:
After locking the external protrusion, it should face upwards.

【Water tank water level and gauge display】

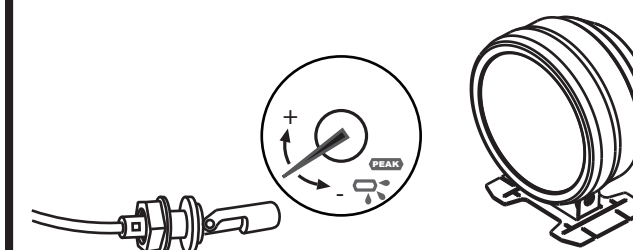

When there is no water, the sensor will sink, and the light will flash rapidly.

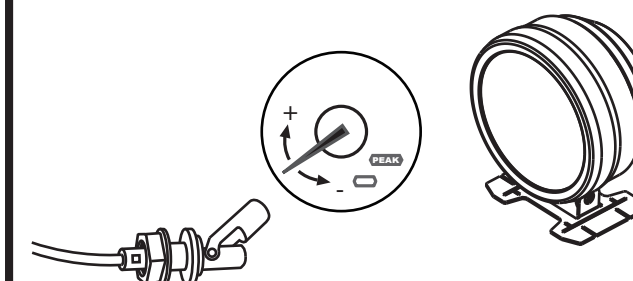

When there is water, the sensor will float, and the light will not flash.

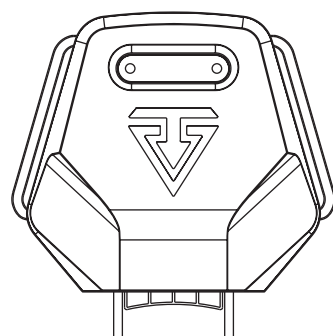

SbPRO+

SMART BOOST PRO
Methanol Injection Control
Power Control

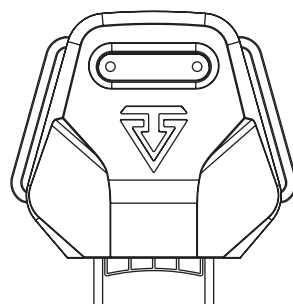

SbPLUS

SMART BOOST PLUS
Methanol Injection Control
Power Control

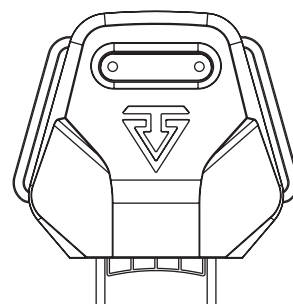

SbMI

SMART BOOST MI
Methanol Injection Control

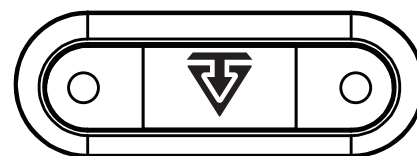

Switch on



Switch on scene
Display the version
of SMART BOOST



Function Mode
Right-Prespray function
Left-Power function

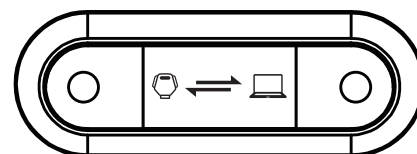

Transmission Mode
Computer is connecting
with equipment.



Power Mode
Press and hold the left button for 6 seconds
to switch off.

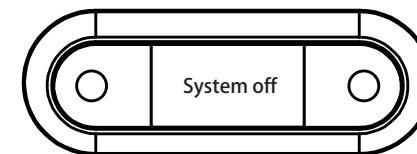

System off

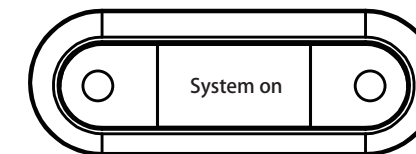

System on

Switch on/off



Pre-spray Mode
Press and hold the right button, pre-spray function
will last for six seconds.

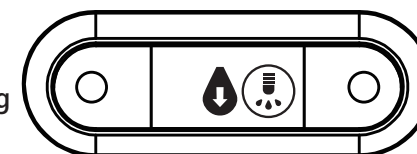

Alert Mode
When the liquid is not enough, Low level alert
will keep flashing, need to add
more water/methanol.

【Optional】

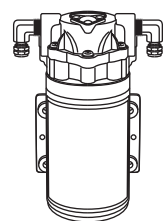

MWI Pump

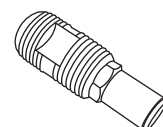

METHANOL / WATER INJECTOR

No.1 150ml/min
No.2 350ml/min
No.3 450ml/min
No.4 550ml/min
No.5 700ml/min
No.6 900ml/min

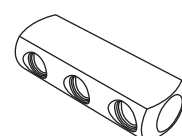

SPLITTING ADAPTOR
I-shape 1-to-6 adaptor,
1/8"NPT

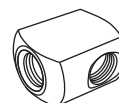

ADAPTOR
FOR METHANOL /
WATER INJECTOR

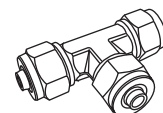

SPLITTING ADAPTOR
T-shape 1-to-3 adaptor, 1/4"

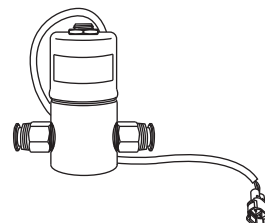

MWI Solenoid Valve

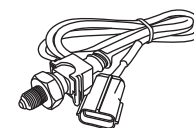

250°C/482°F
INTAKE TEMP SENSOR

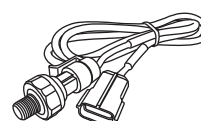

10 Bar/150 PSI
Fuel/Oil/Map
Air PRESSURE SENSOR

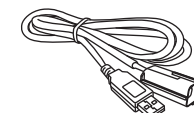

USB TUNING CABLE

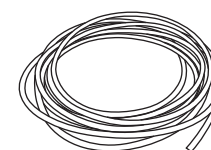

TEFLON REINFORCED HOSE
•6m in length

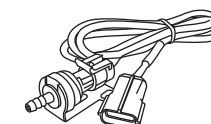

4 Bar/60 PSI BOOST SENSOR



EXHAUST TEMP SENSOR

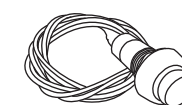

SWITCH FOR PRE-SPRAY
SWITCH FOR PIGGYBACK

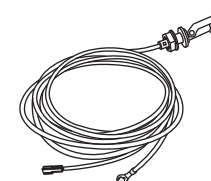

Liquid Level Sensor Wire

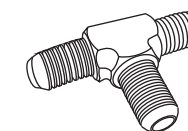

METAL HOSE FITTINGS
T-shape 1-to-2 splitter, 1/4"

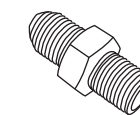

METAL HOSE FITTINGS
• Metal fittings for braided racing hose

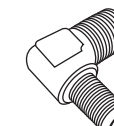

METAL HOSE FITTINGS
L-shape 3/8" to 1/4" adaptor

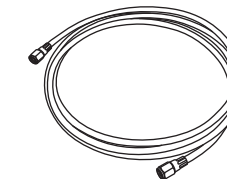

BRAIDED RACING HOSE
1x braided hose, 10 feet / 300cm in length
2x 1/4" to 1/8" adaptor

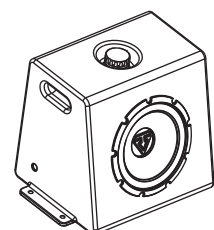

METHANOL/WATER TANK
12L Type/3.2Gallon

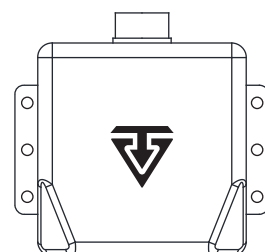

METHANOL/WATER TANK
5.4L Type/1.4Gallon

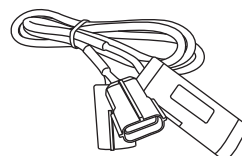

BLUETOOTH MODULE for AirForce GO

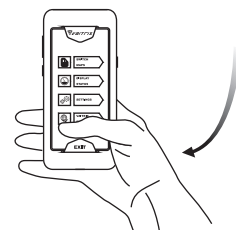

VAITRIX AirForce GO Bluetooth application
Switching by just one click in the app.
(Available on Android System only)

★ Please switch the program in the range of
excellent network signal.

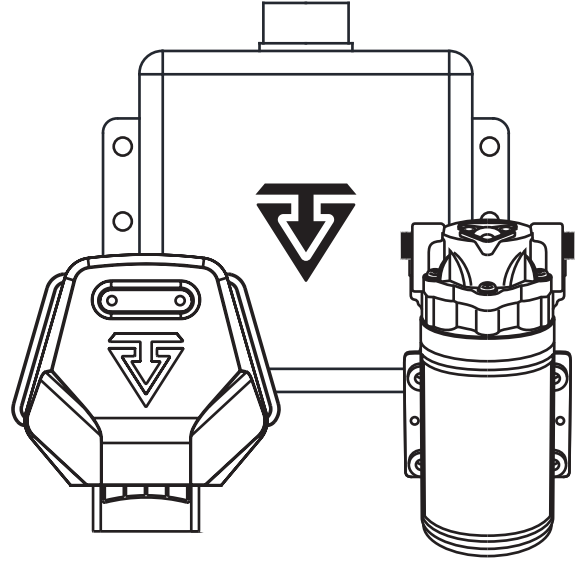

外掛型水噴安裝指南

電路安裝示意圖

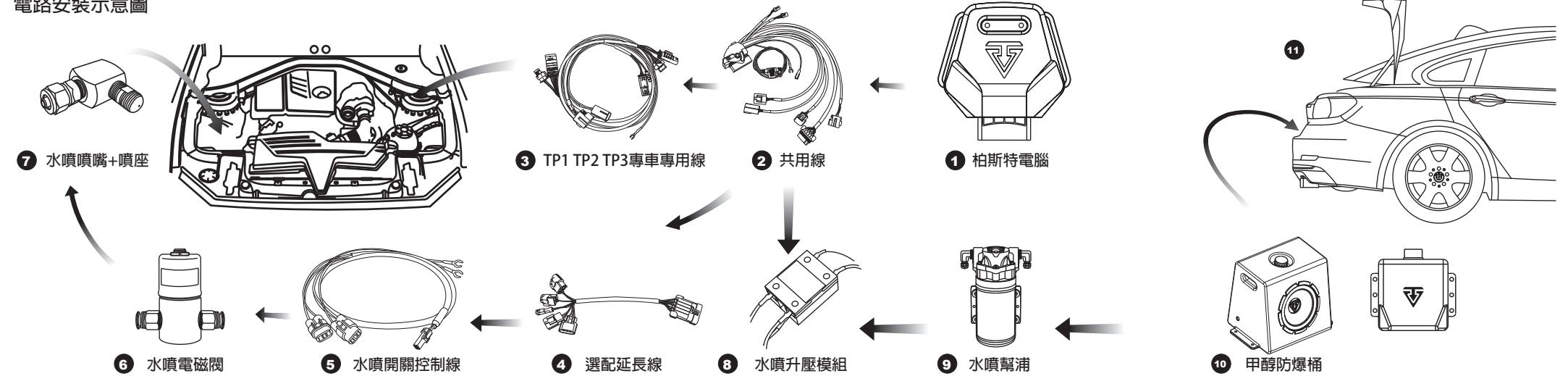

水路安裝示意圖

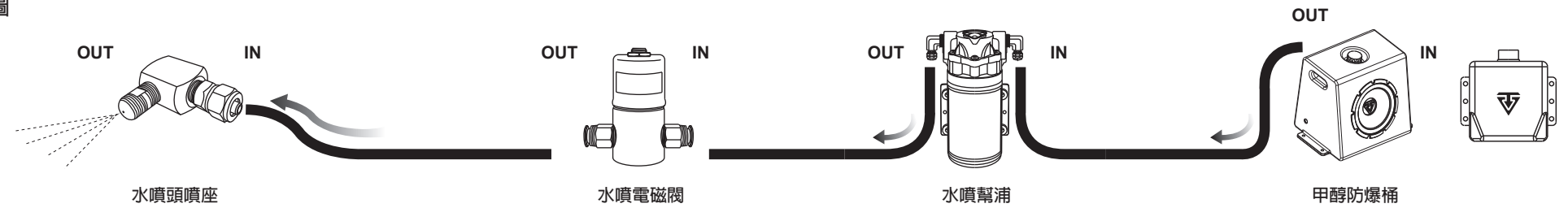

1

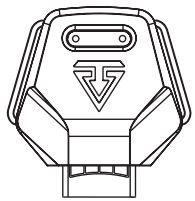

可以搭配以下四款

- VAITRIX外掛電腦專家版(可控制增壓&水噴)
- VAITRIX外掛電腦玩家版(可控制增壓&水噴)
- VAITRIX外掛電腦入門版(可控制增壓)
- VAITRIX外掛電腦水噴版(可控制水噴)

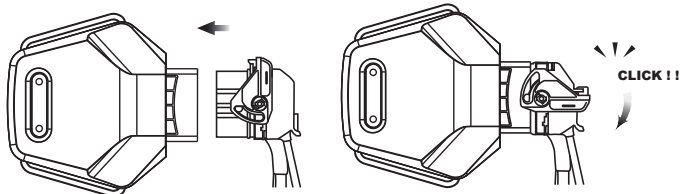

●VAITRIX外掛電腦與上共用線-緊配

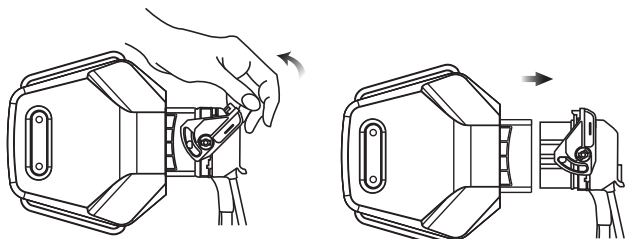

●VAITRIX外掛電腦與接共用線-卸除

2

【共用線】

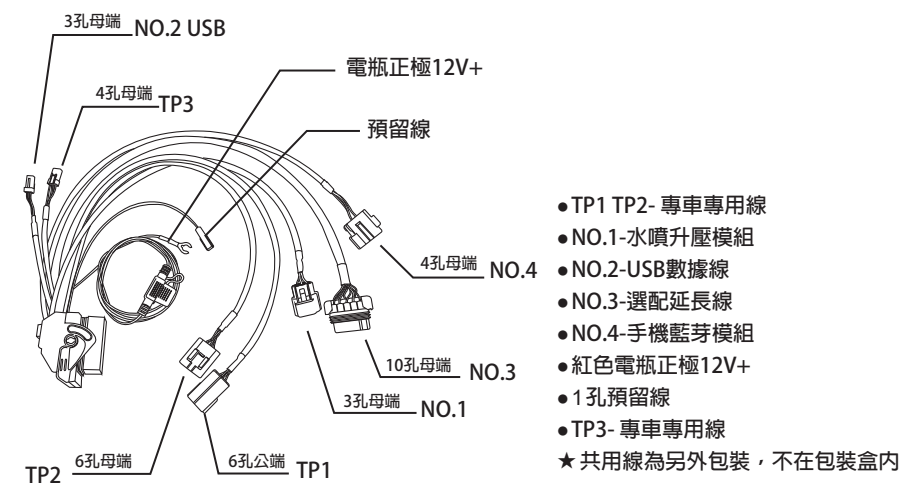

3

【共用線與專用線連接】

- 共用線TP1、TP2與專用線TP1、TP2對接
- 專用線另一端接車子，車子端接插位置可參考官網INFORMATION內的外掛安裝說明書，出貨時亦會於夾鏈袋內附上一張安裝位置示意圖。

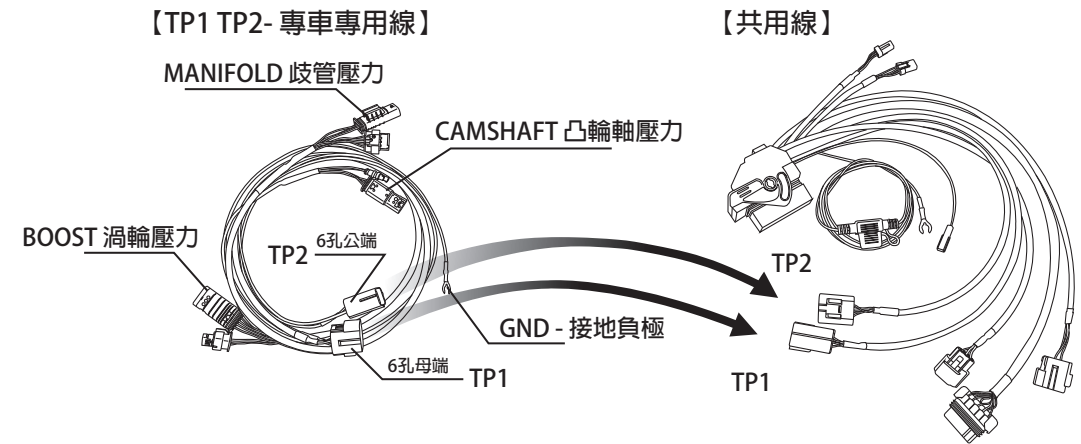

MANIFOLD、CAMSHAFT 和 BOOST 連接器的位置請參考線束中所附的示意圖。

- 有任何問題請把這三個接頭都接回原廠接頭。

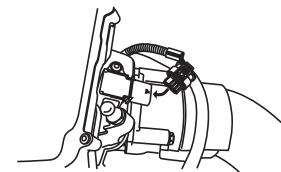

- 請對照網路安裝說明書，選找正確MANIFOLD(節氣門後)位置

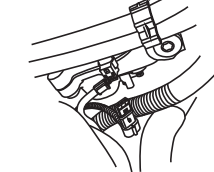

- 請對照網路安裝說明書，選找正確CAMSHAFT(凸輪軸)位置

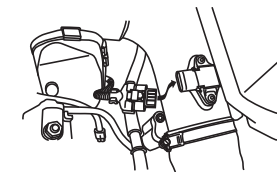

- 請對照網路安裝說明書，選找正確BOOST(節氣門前)位置

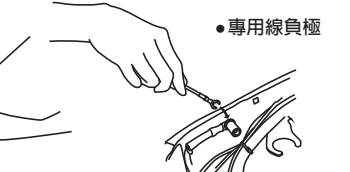

- 注意負極是否導通，負極搭鐵請勿鎖在烤漆

●共用線 (正極)

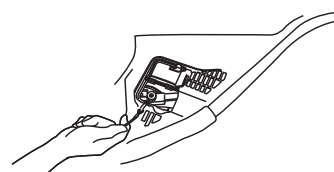

- 注意正極請接電瓶正電

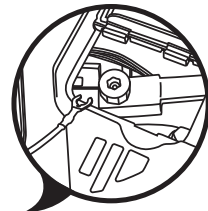

- 有任何問題可以先移除電瓶正極12V+恢復原廠
- 有任何問題可以先移除保險絲20A恢復原廠



請注意，安裝時，如果正負極線接觸或安裝位置錯誤，會導致內部PCB短路並燒毀。

4 【選配延長線接頭用途說明】

- 延長線NO.3與共用線NO.3對接

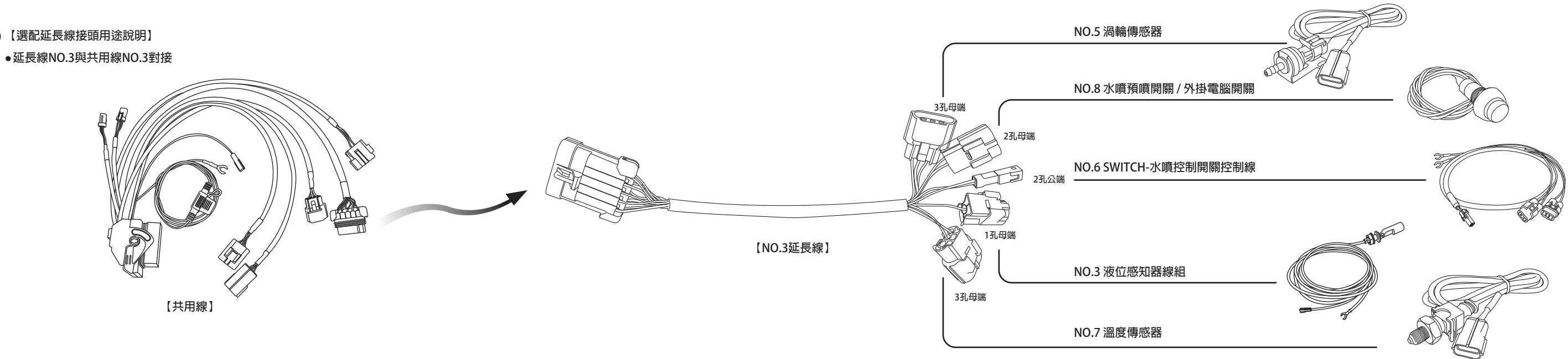

5 【水噴開關控制線】

- NO.6-水噴開關控制線上6號接頭
- SW1-水噴電磁閥
- SW2-水噴電磁閥(選配第二組使用)
- GND-接地負極

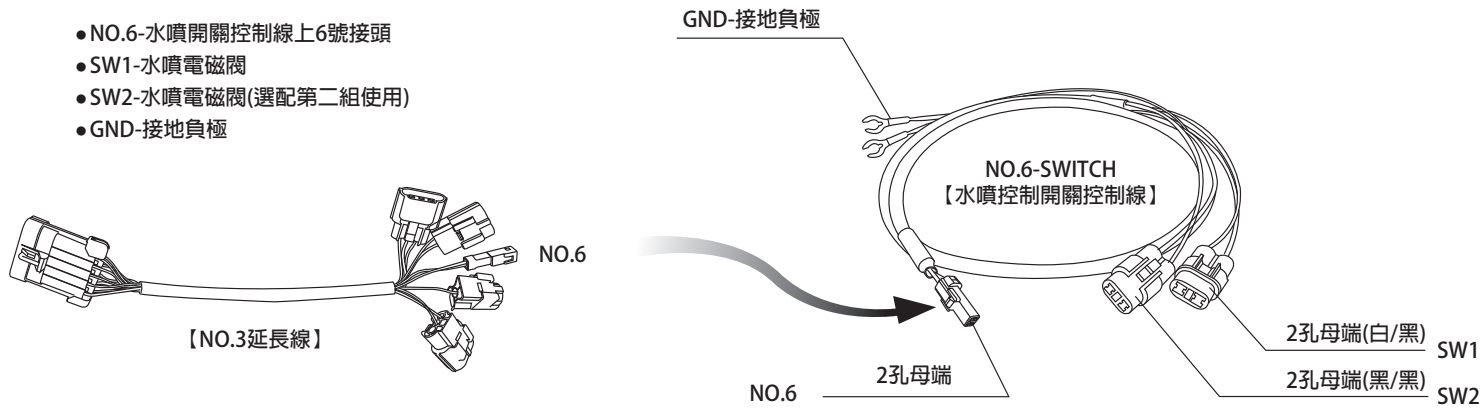

6 【水噴電磁閥】

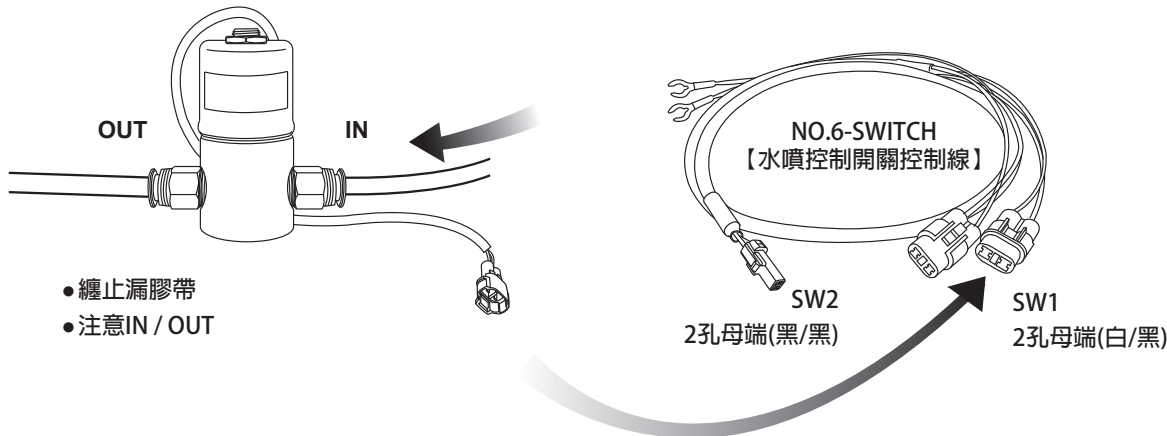

7 【水噴噴嘴+噴座】

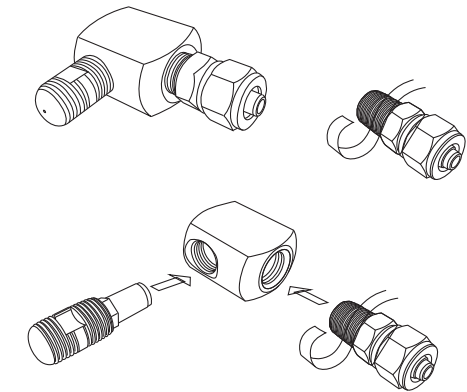

- 止漏膠帶纏繞時請注意，需要與螺紋反方向

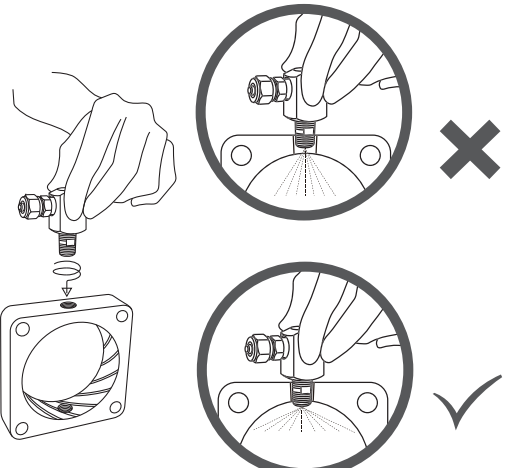

- SPACER墊寬片，注意專車專用，請正確選擇款式

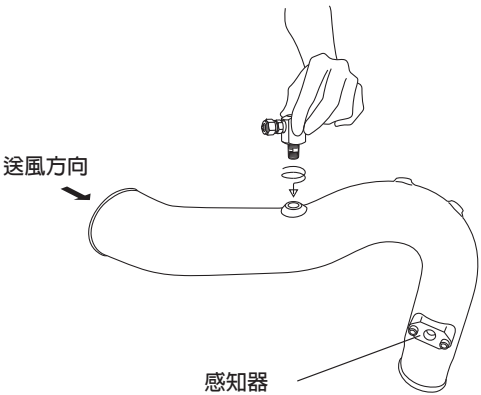

- 渦輪管帶水噴孔，注意專車專用，請正確選擇款式鑽水噴孔注意，孔位需要在感知器前

8 【水噴升壓模組】

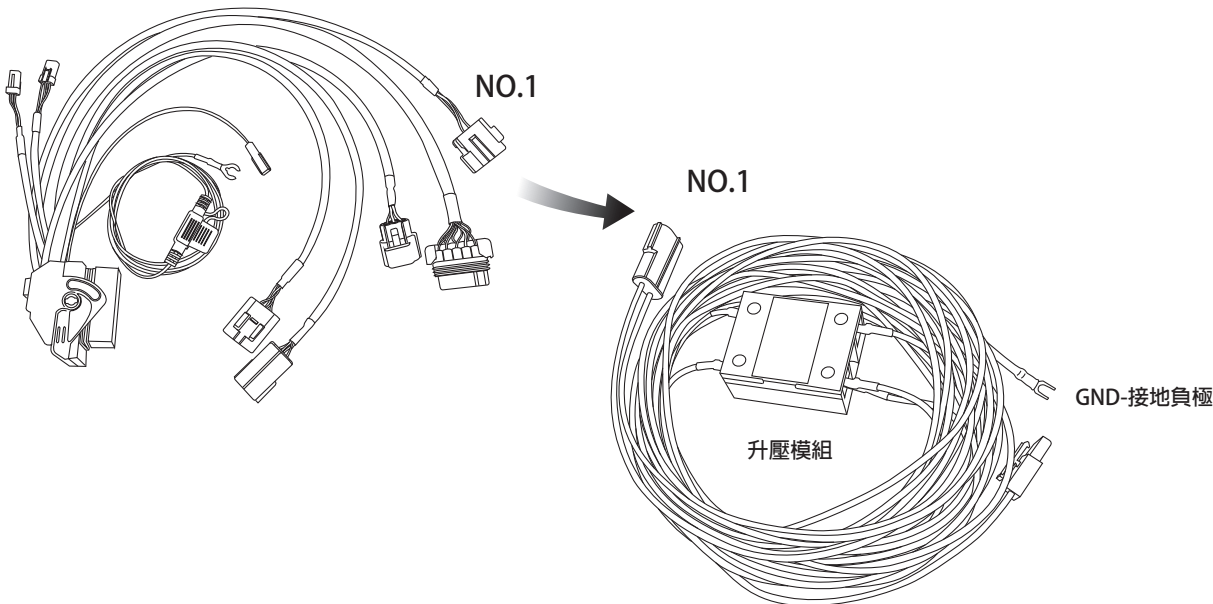

9 【升壓模組&水噴幫浦安裝】

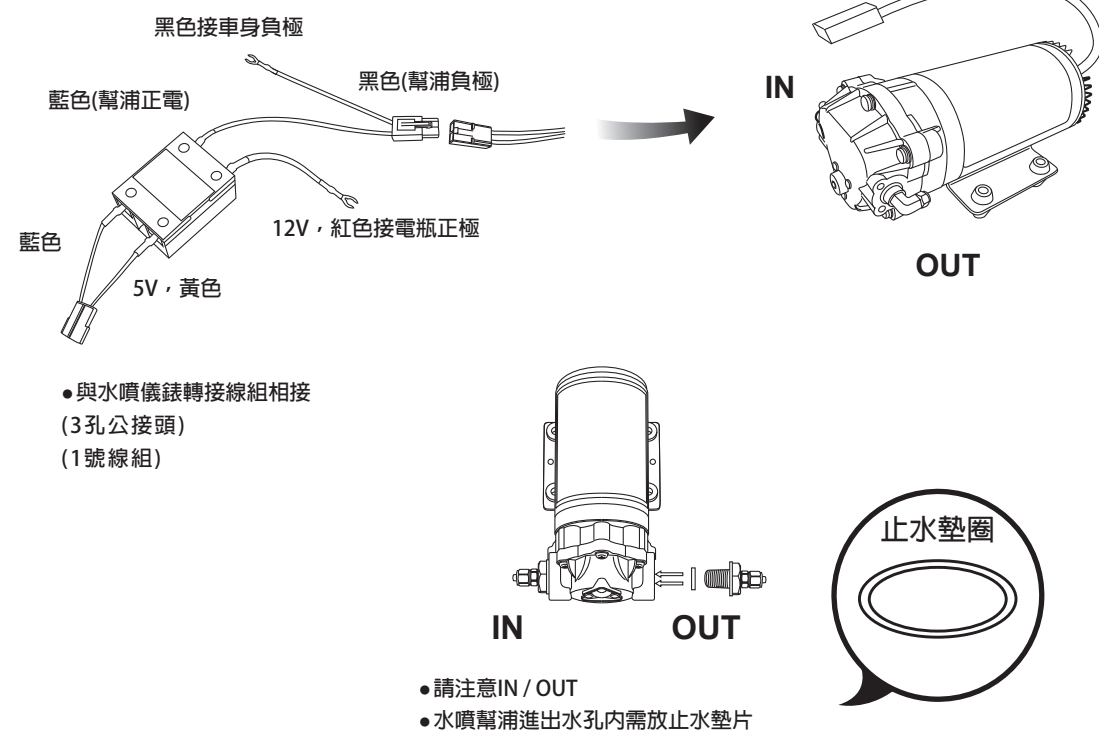

10 【甲醇防爆桶】

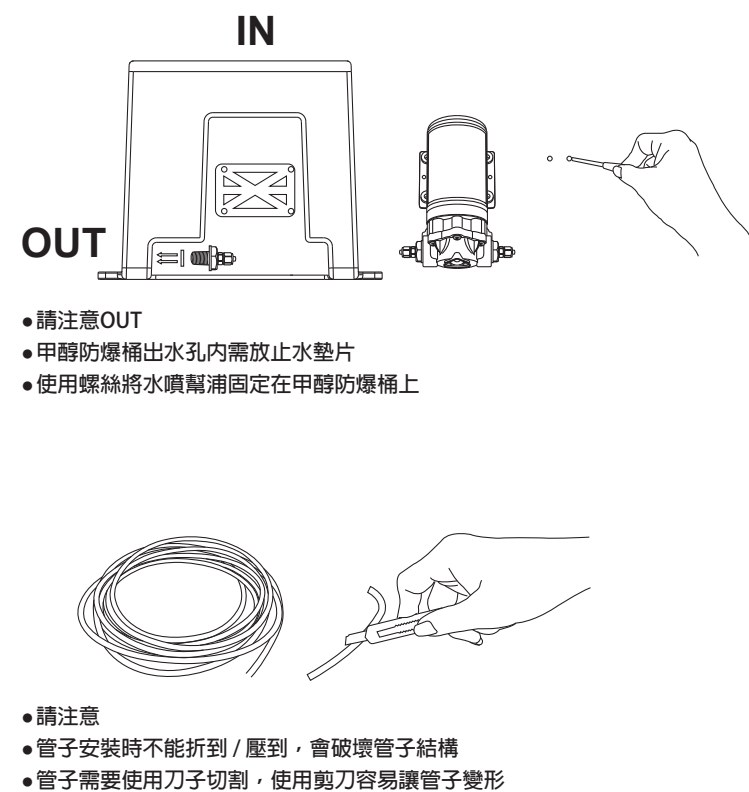

11 【放置後車箱】

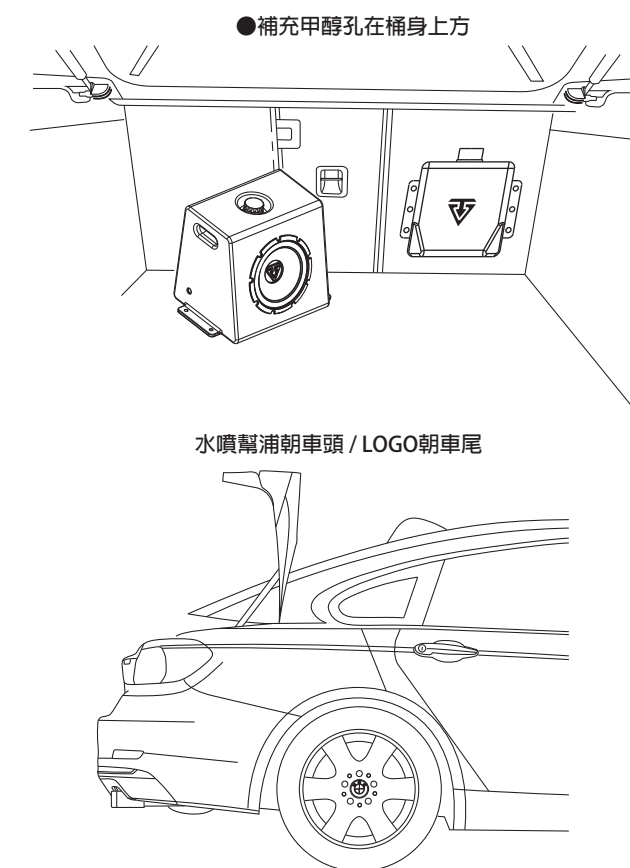

液位感知器安裝重點(選配)

外部示意圖

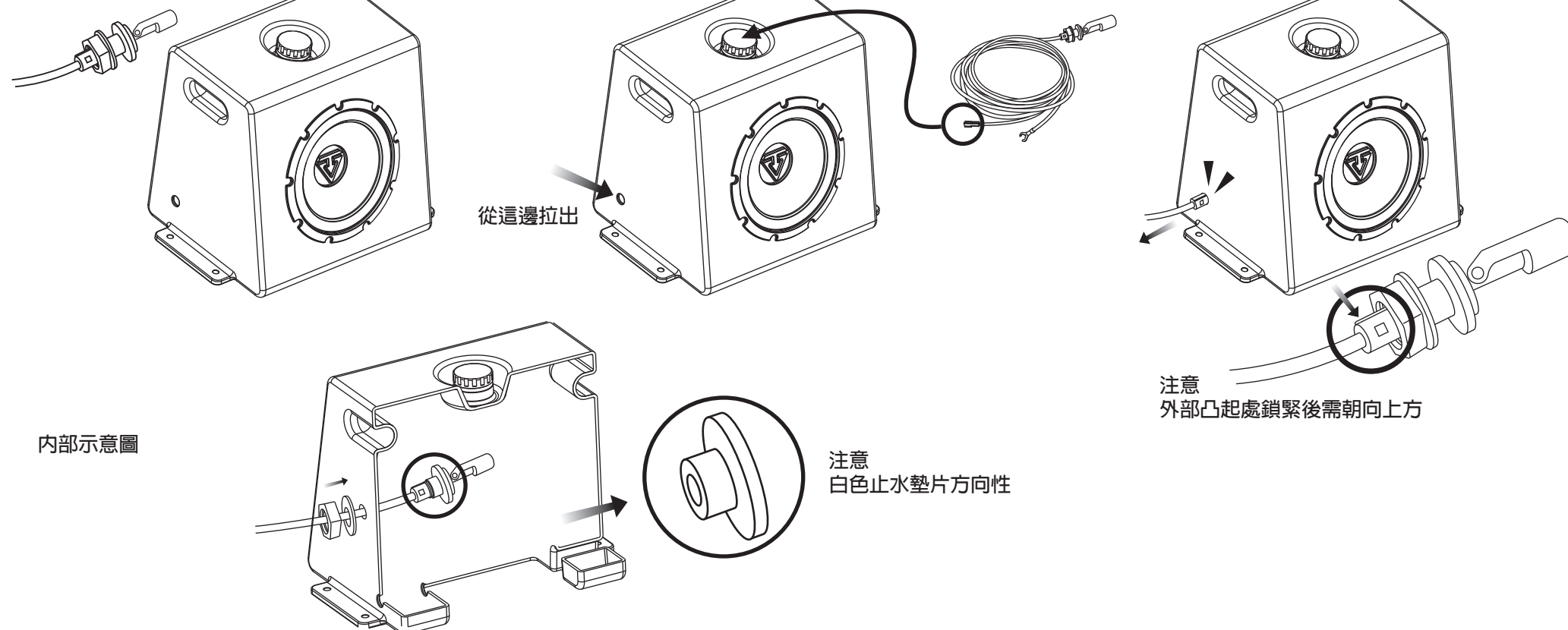

水噴桶水位與儀表顯示

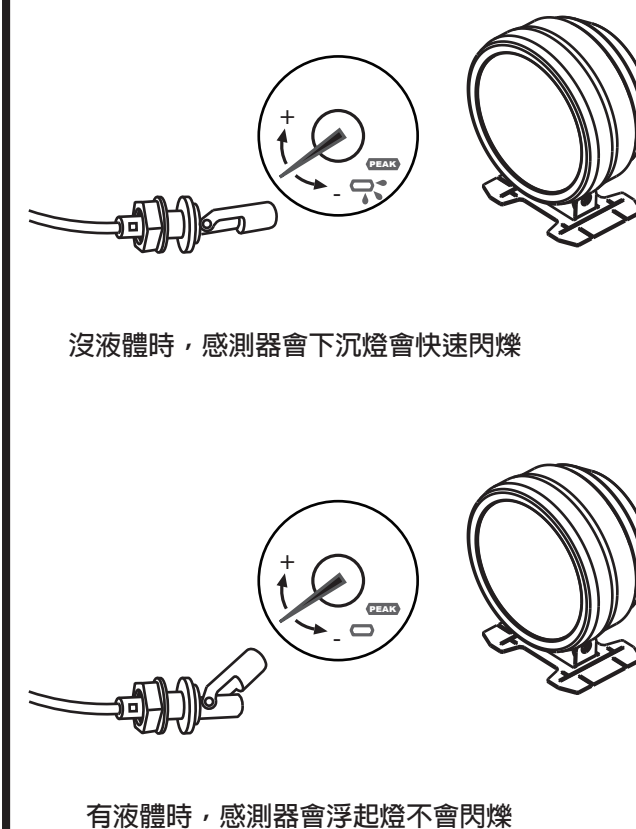

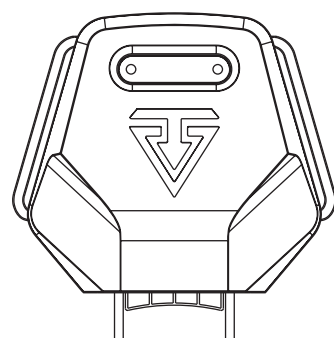

SB PRO+

專家版

控制水噴
控制動力

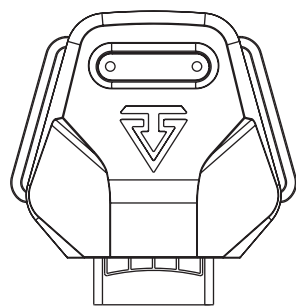

SB PLUS

玩家版

控制水噴
控制動力

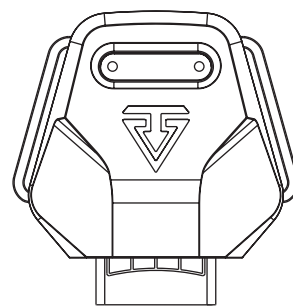

SB MI

單水噴版

控制水噴

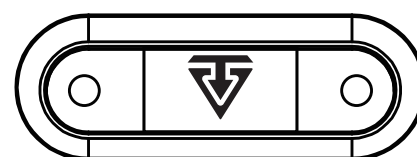

開機畫面



開機畫面
顯示外掛電腦款式名稱

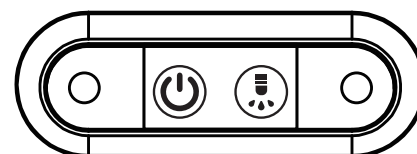

選項模式
右邊預噴功能
左邊電源功能

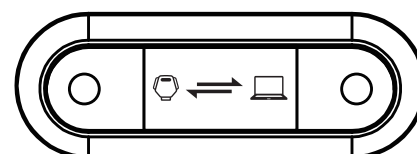

傳輸模式
電腦與設備連線中



電源模式
左邊按鍵長按倒數6秒關機

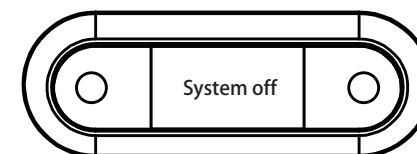

System off

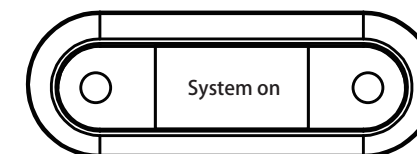

System on

開關機顯示



預噴模式
右邊按鍵長按預噴
持續作動六秒

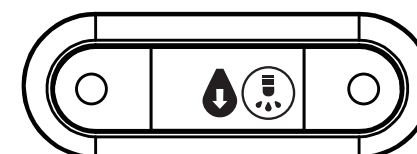

警示模式
水量不足，低水位警示
持續閃爍，需加水/甲醇

【選配 加購區】

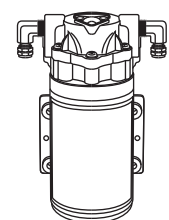

水噴幫浦

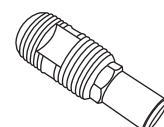

1號 150 ml/min
2號 350 ml/min
3號 450 ml/min
4號 550 ml/min
5號 700 ml/min
6號 900 ml/min

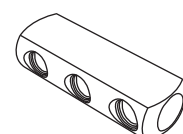

管路一分六接頭

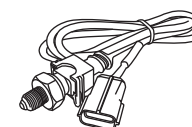

溫度傳感器

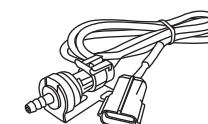

渦輪傳感器

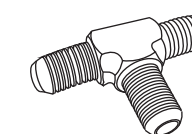

T形金屬管轉接座

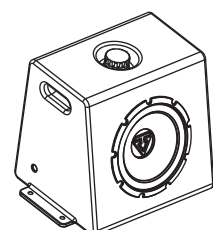

12L 水噴桶

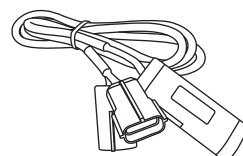

手機藍芽模組

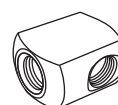

噴嘴座

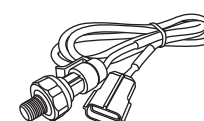

油壓傳感器



排溫傳感器

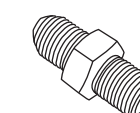

金屬管轉接座

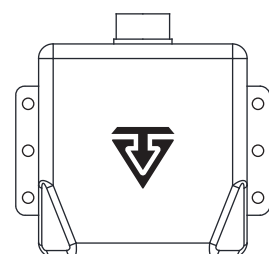

5.4L 水噴桶

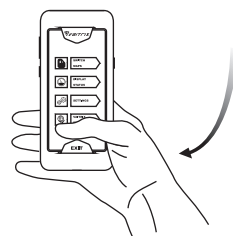

VAITRIX AIR FORCE ONE藍芽模組
僅限Android手機使用(一機在手切換自如)
★請在網路訊號極佳範圍切換程序

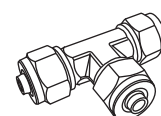

T型三通

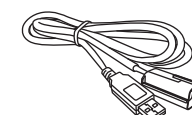

調適數據線

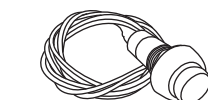

水噴預噴開關 / 外掛電腦開關

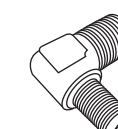

L形金屬管轉接座

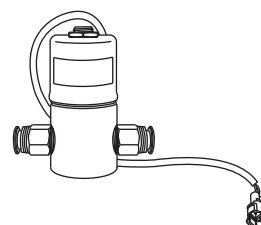

水噴電磁閥

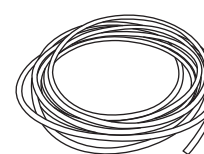

鐵氟龍管

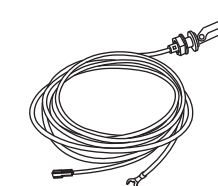

液位感知器線組



10英尺/300公分
金屬編織鐵氟龍軟管